



2019-21 RAM 1500 Rear Bumper

Thank you for choosing Rough Country for all your vehicle needs.

Please read instructions before beginning installation. Check the kit hardware against the kit contents shown below. Be sure you have all needed parts and know where they go.

If question exist, please call us @1-800-222-7023. We will be happy to answer any questions concerning this product.

Check all fasteners for proper torque. Check to ensure for adequate clearance between all components.

Periodically check all hardware for tightness.

KIT CONTENTS:

- 2" Flush Mount LED Cube Light Kit x1
- Rear Bumper x1
- Sensor Install Hardware Kit x1
- Flush Light Extension Harness x1

TOOLS NEEDED:

- 15mm Wrench or Socket
- 16mm Wrench or Socket
- 18mm Wrench or Socket
- Clip Removal tool
- Small Pry Tool

HARDWARE INCLUDED:

- 12mm Flag Nuts x 2
- 4mm Lock Washer x 2
- 4mm Flat Washer x 4
- 4mm x 10mm Button head screw x 2
- 4mm Hex Nut x 2
- 12mm Lock Washer x 4
- 12mm Flat Washer x 4
- 12mm x 35mm Hex Bolt x 4



Torque Specs:

Size	Grade 5	Grade 8	Size	Class 8.8	Class 10.9
5/16"	15 ft/lbs	20ft/lbs	6MM	5ft/lbs	9ft/lbs
3/8"	30 ft/lbs	35ft/lbs	8MM	18ft/lbs	23ft/lbs
7/16"	45 ft/lbs	60ft/lbs	10MM	32ft/lbs	45ft/lbs
1/2"	65 ft/lbs	90ft/lbs	12MM	55ft/lbs	75ft/lbs
9/16"	95 ft/lbs	130ft/lbs	14MM	85ft/lbs	120ft/lbs
5/8"	135ft/lbs	175ft/lbs	16MM	130ft/lbs	165ft/lbs
3/4"	185ft/lbs	280ft/lbs	18MM	170ft/lbs	240ft/lbs



INSTALLATION INSTRUCTIONS

1. Remove the license plate from the rear bumper using a Philips bit driver. **See Photo 1.**
2. Using a 15mm socket. Remove the (2) bolts behind the license plate. **See Photo 2.**

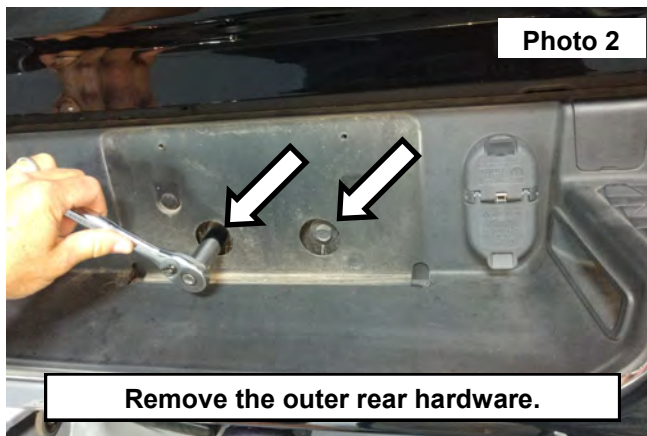
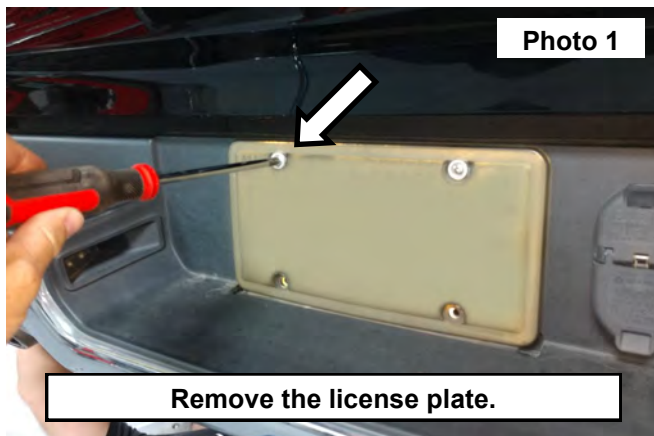

3. Locate the bumper harness. Release the center tab. **See Photo 3.**
4. Pull the larger locking tab out of the plug. Then disconnect the plug from the vehicle. **See Photo 4.**



5. Remove the harness from the connector on the frame. **See Photo 5.**
6. Support the rear bumper. Do not get under the bumper with out supporting first.
7. Remove the (2) nuts on each side of the frame mount using a 16mm socket. **See Photo 6.**

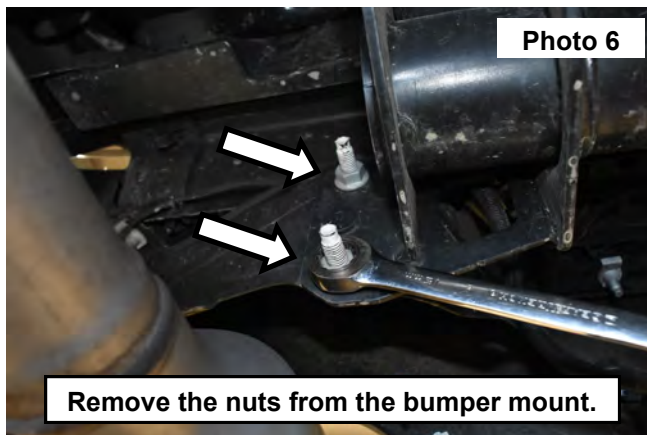
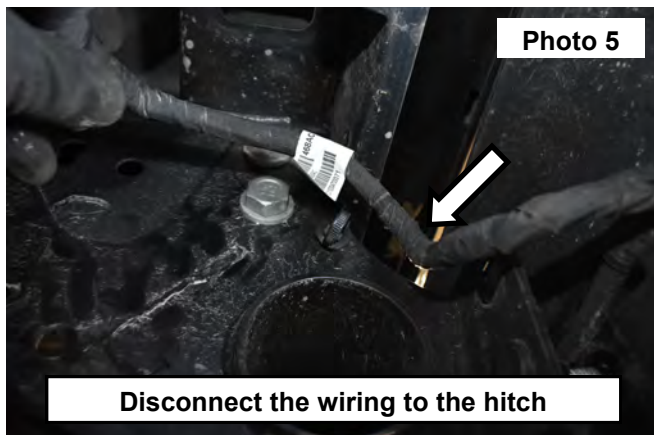

8. Remove the rear bumper from the vehicle and set in a place to remove the remaining parts from the bumper. **See Photo 7.**
9. Use a pry tool to remove the trailer plug. **See Photo 8.**



10. Install the trailer plug into the new bumper. **See Photo 9.**
11. If factory equipped, remove the (4) rear sensors from the bumper using a small pry tool to release the clips from each side of the sensor. **See Photo 10.**

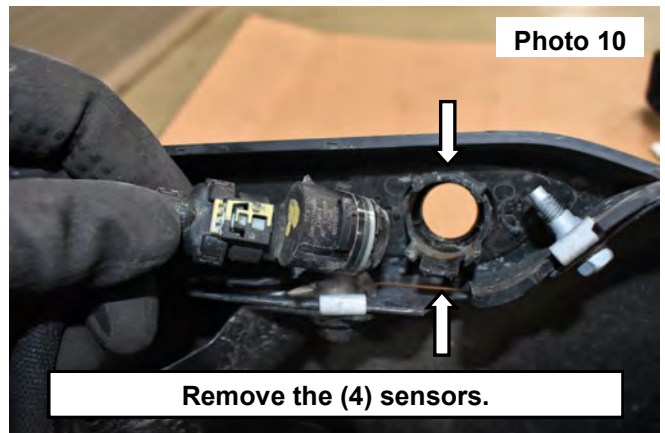

12. Using a pry tool. Remove the bumper harness from the wiring clips and retain the harness. **See Photos 11 and 12.**
13. Install the harness onto the rear bumper.



14. Connect the wiring harness to the trailer light plug. **See Photo 13.**
15. Install the supplied backing pad onto each of the sensors. **See Photo 14.**



16. Locate the supplied sensor clips shown in **Photo 15.**
17. Install the sensors into the rear bumper using the supplied sensor clips to secure the sensor. **See Photo 16.**

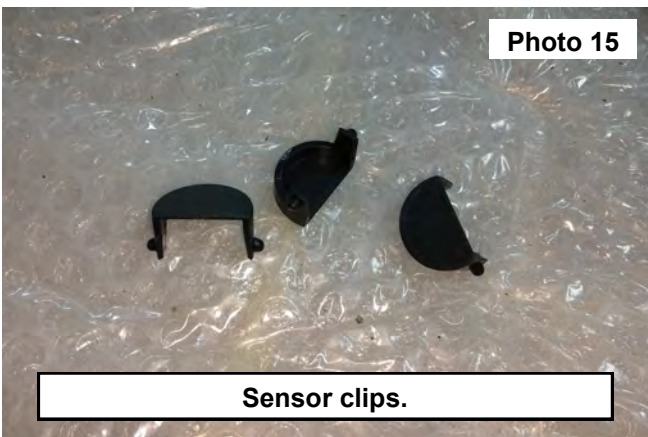

18. If factory equipped, remove the sensor from the behind the license plate mount using a 7mm wrench. **See Photo 17.**
19. Install the sensor on the (2) welded brackets on the back of the bumper using (2) of the supplied 4mm hex head bolts (4) 4mm flat washers and (2) of the 4mm nylock nuts. Tighten the sensor to the bumper using an 11mm socket and wrench but do NOT over tighten. **See Photo 18.**
20. Plug the bumper wiring harness into the sensor.

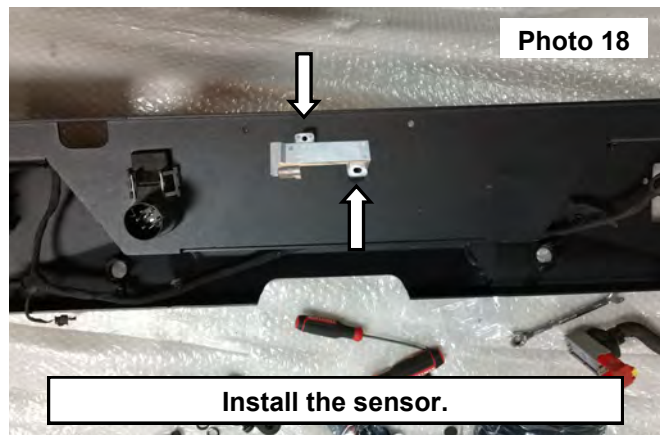
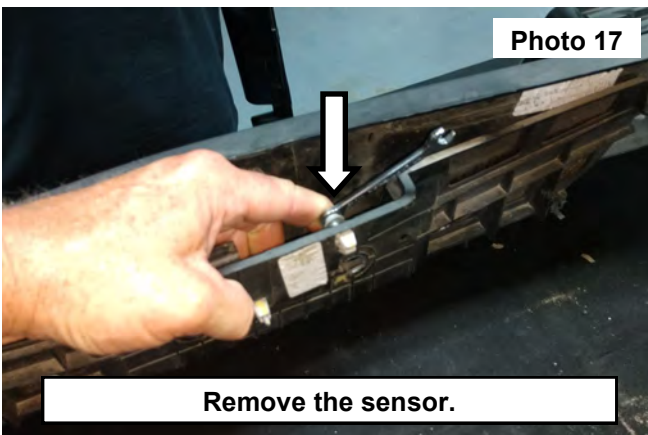

21. Install the flush mount lights into the rear bumper using the supplied hardware with the lighting kit. **See Photos 19 and 20.**
22. Install the wiring harness onto the vehicle using the corresponding instruction sheet with the lighting kit.

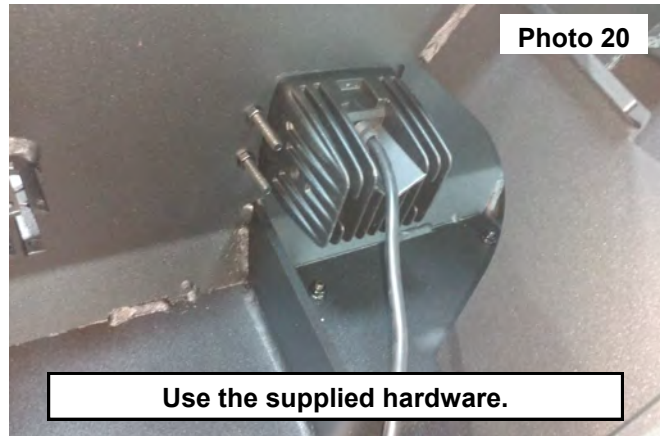

23. Locate the rear bumper installation hardware, (2) flag nuts (4) 12mm hex head bolts and (4) 12mm flat washers. **See Photo 21.**
24. Support the bumper then Install the bumper onto the rear of the vehicle.
25. Secure the bumper using (1) of the supplied flag nut to the bumper side. Then secure the flag nuts using (2) of the 12mm hex head bolts and (2) 12mm flat washers. **See Photo 22.**

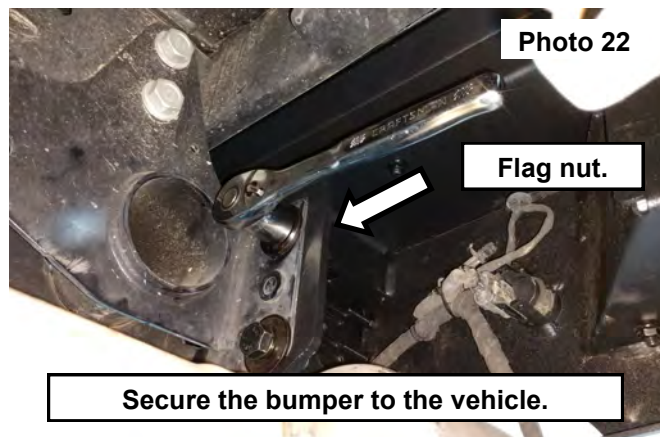
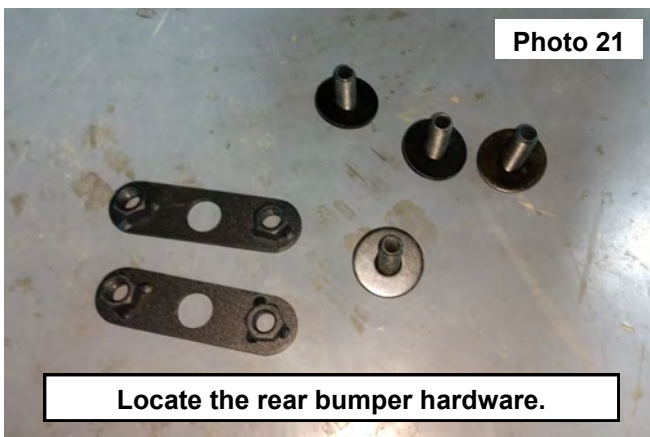

26. Center the bumper to the vehicle. Then adjust the height of the bumper along the bottom edge of the tailgate. **See Photo 23.**
27. Tighten the (4) bumper bolts using a 18mm socket.
28. Connect the (2) flush mount LED lights to the installed harness.
29. Connect the OE bumper harness. Secure the locking feature of the plug and compress the outer lock. **See Photo 24.**

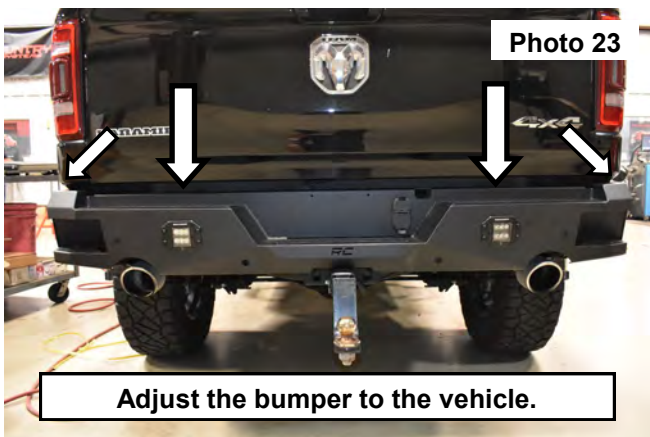

30. Locate the supplied license plate light kit. **See Photo 25.**
31. Install the license plate using the supplied license plate light kit. Connect the lights into the vehicles power supply. **See Photo 26.**

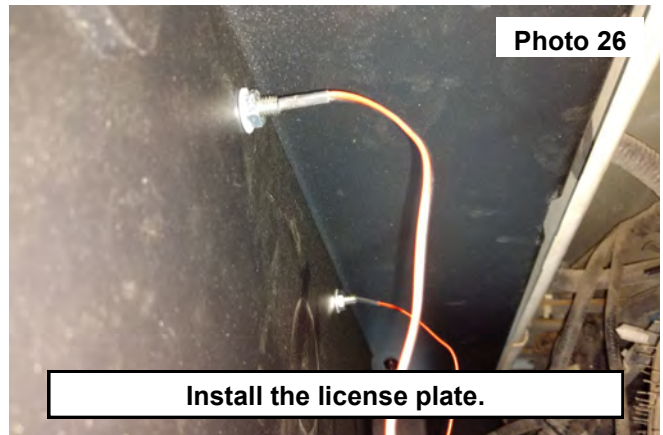

By purchasing any item sold by Rough Country, LLC, the buyer expressly warrants that he/she is in compliance with all applicable, State, and Local laws and regulations regarding the purchase, ownership, and use of the item. It shall be the buyers responsibility to comply with all Federal, State and Local laws governing the sales of any items listed, illustrated or sold. The buyer expressly agrees to indemnify and hold harmless Rough Country, LLC for all claims resulting directly or indirectly from the purchase, ownership, or use of the items.

