

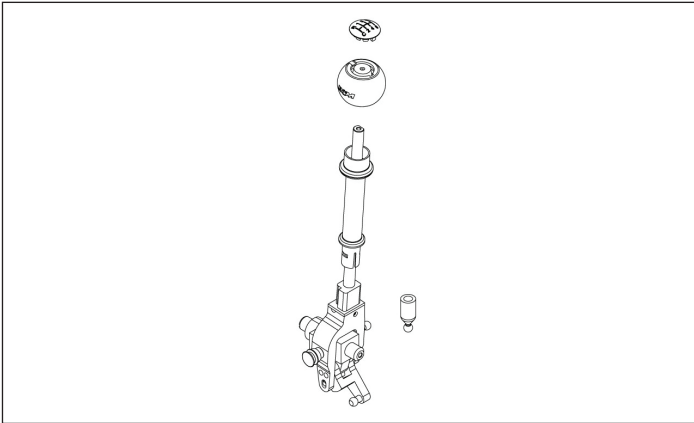

INSTALLATION INSTRUCTIONS
 Part No. 45209
PRECISION MANUAL SPORTSHIFTER™
FOR 2021-2024 FORD BRONCO
WITH 2.3L ENGINE &
7-SPEED MANUAL TRANSMISSION



PARTS LIST

DESCRIPTION	QTY
CAP	1
SHIFT KNOB	1
SHIFT LEVER	1
LOCKOUT COLLAR [SHIPS ON SHIFT LEVER]	1
BALL TIP EXTENSION & SET SCREW ASSEMBLY	1

BEFORE STARTING

Take a moment to read and understand these instructions. Use the parts list to verify your kit's contents. In the unlikely event that any parts are missing, please contact B&M Technical Support for replacements.

We recommend that you retain all factory parts.

WORK SAFELY:

- Park the vehicle on a clean, level surface, and turn the ignition switch OFF.
- Chock the wheels, and set the parking brake.

NOTES

Installation requires moderate mechanical skill. If this job is beyond your abilities, seek the services of a qualified technician.

The shifter mechanism is precision-assembled at our factory. **Any modification of the shifter or disassembly beyond what is described in these instructions will void its warranty, and may cause it to malfunction.** Disassemble items **only** as described in these instructions.

If you do not understand any part of these instructions, please call **B&M Technical Support** at **(866) 464-6553** for assistance.

REMOVE THE STOCK SHIFTER

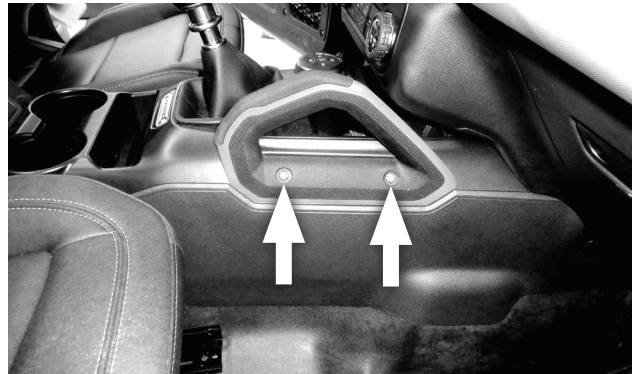

1. **Remove the passenger grab handle** from the center console (2 screws).



2. **Use a plastic trim removal tool** to separate the console panel from the console base, and lift the rear of the panel upward.

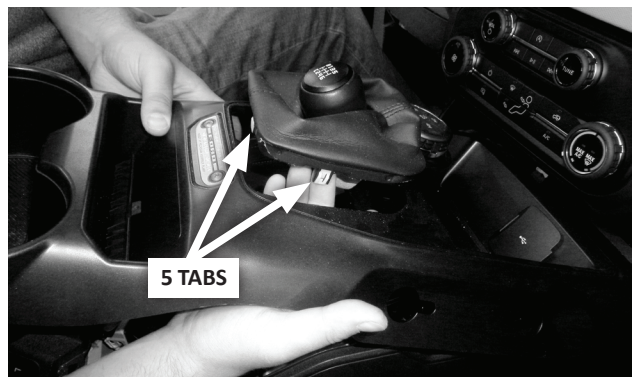

3. **Reach under the panel, and detach the boot frame** from the panel (secured with 5 plastic tabs).



4. Turn the boot frame diagonally, and carefully lower it through the panel.



7. Remove the 2 screws from the center bracket.

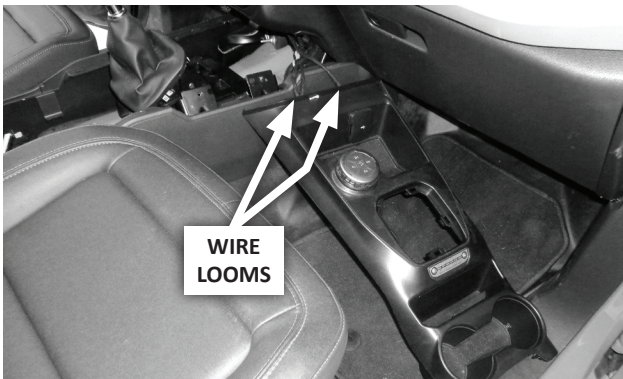

5. Carefully move the console panel to the passenger side.

CAUTION: Take care not to snag, or place excess strain on, the panel's wire looms.

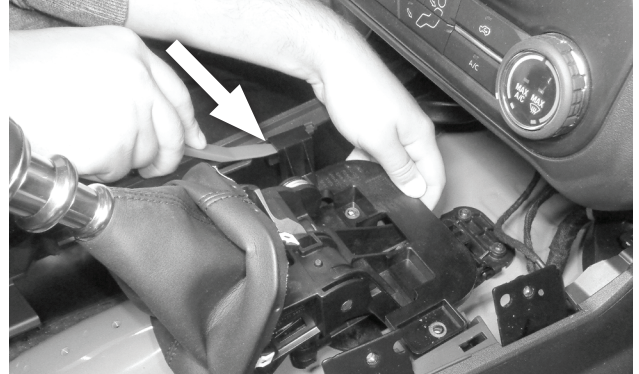

8. Separate the center bracket from the driver side console and remove the bracket.

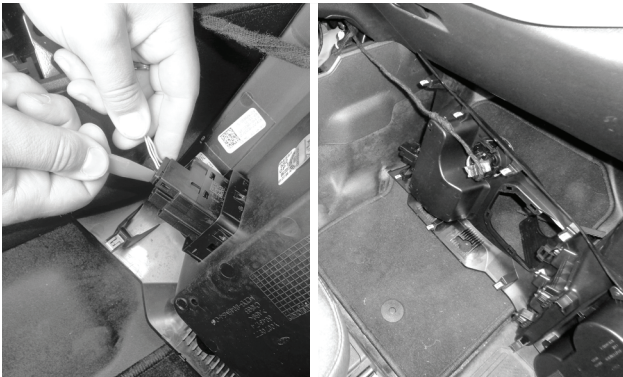

6. Disconnect the 2 electrical plugs from the USB sockets, and allow the panel to rest on the floor.



9. Move the passenger seat fully rearward, then use a forked plastic trim removal tool to remove the plastic push pin at the rear of the passenger side console.

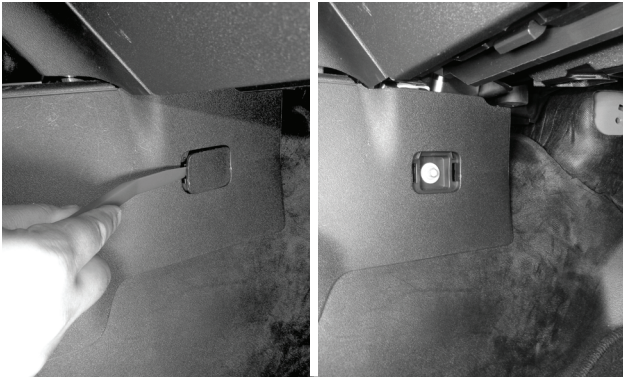

10. Remove the trim cover at the front of the passenger side console, then remove the screw.

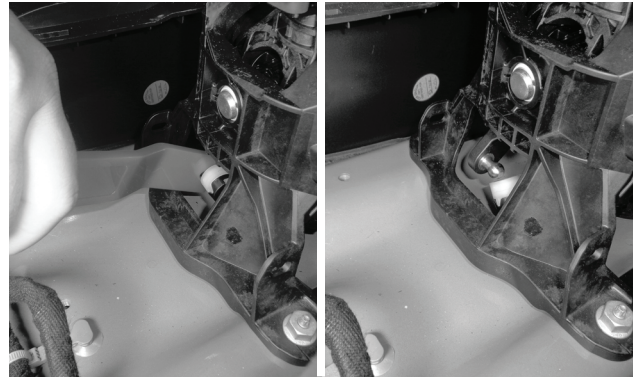

13. Use a forked trim tool to pop each cable end (socket) off of its ball.

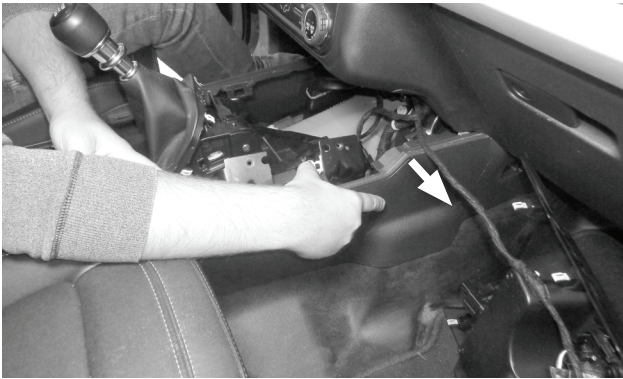

11. Carefully flex the front of the passenger side cover a few inches away from the console (for access to the cable ends in the next step).

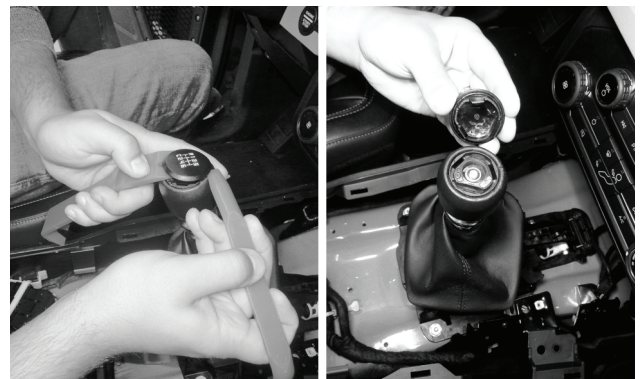

14. Use a trim tool to start separating the cap from the shift knob. Then work a second trim tool under the cap to release the 3 tabs from their slots. Remove the cap.

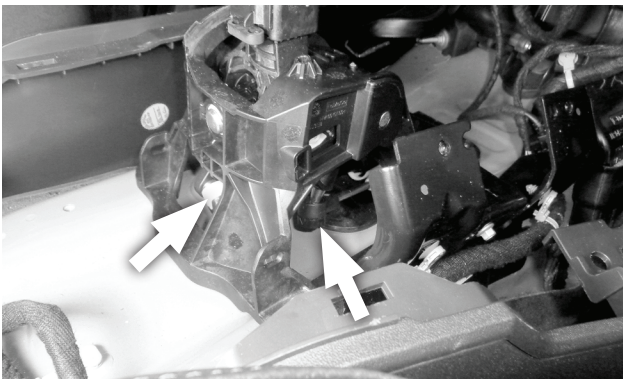

12. Note the 2 cable ends under the shifter (ball-in-socket connections); one at the rear, one at the passenger side.

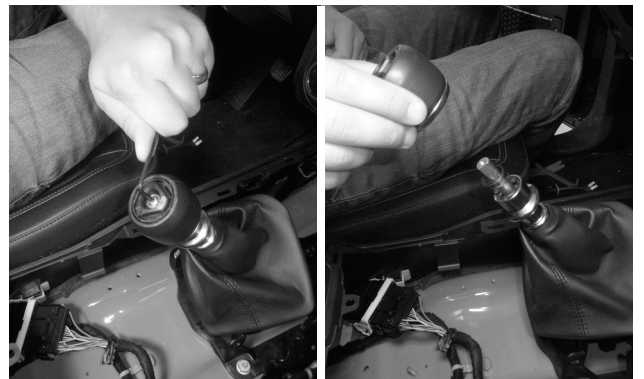

15. Remove the Allen screw, then remove the shift knob.



16. Remove the lockout spring and bushing, then remove the boot assembly.

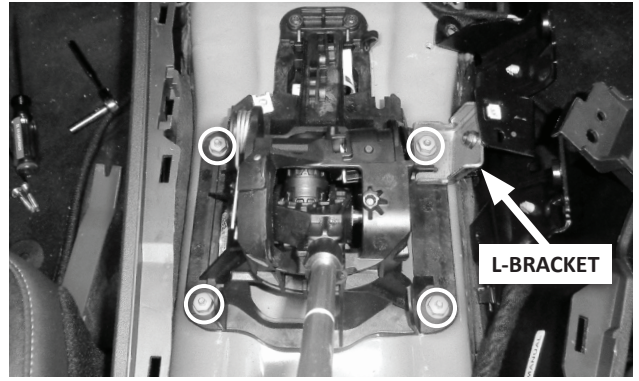

19. Remove the 4 shifter mount nuts, and the L-bracket at the front passenger side corner.

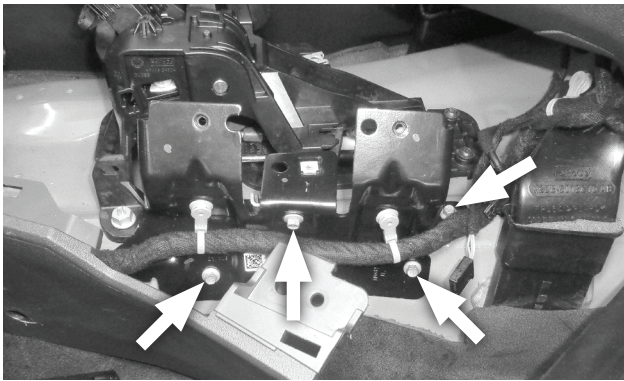

17. Remove the 4 screws from the passenger side bracket, and move the bracket away from the shifter.



20. Disengage the 2 white cable bushings from the front of the shifter housing (1 on each side).

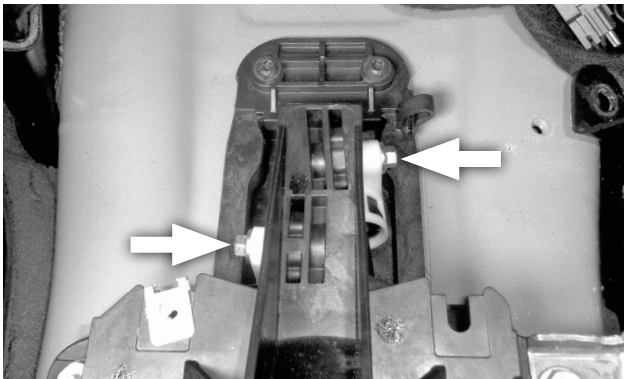

18. Remove the screws from the 2 white cable bushings (one on each side) at the front of the shifter housing.

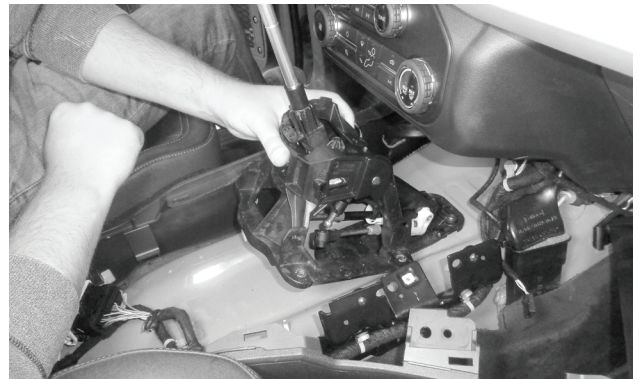

21. Remove the shifter assembly from the vehicle.



22. On the workbench, move the shift lever rearward, and use an angled dental pick to remove the long (lateral) pivot pin's retaining clip.

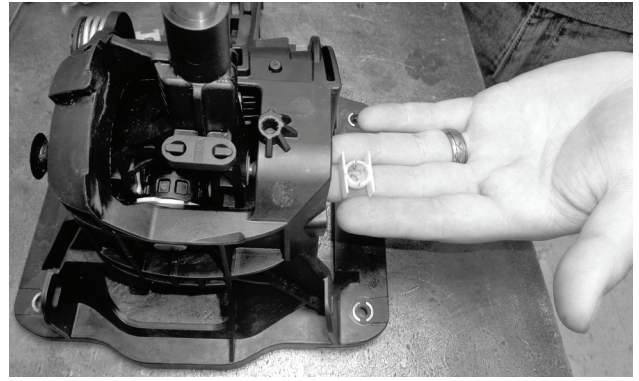

25. Remove the bearing cup from the shifter assembly.

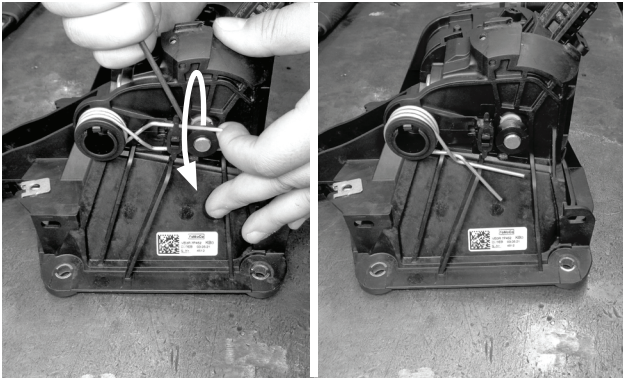

23. On the driver side of the shifter assembly, lift the upper leg of the centering spring off and away from its groove on the head of the long pivot pin, and let it rest below the pin.

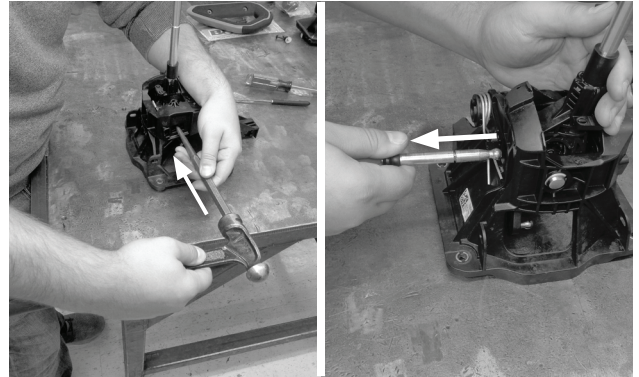

26. Remove the long pivot pin from the shifter assembly. Its tight fit may require tapping it out with a punch or drift.

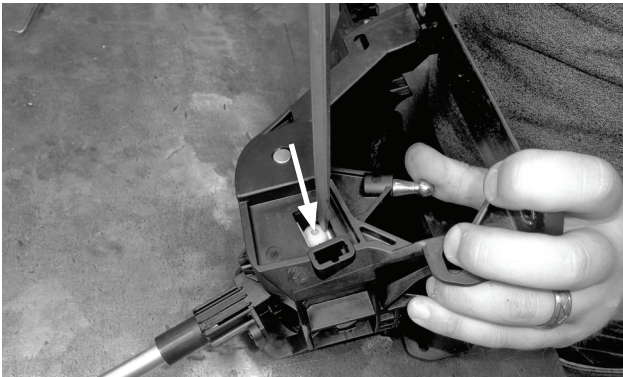

CAUTION: The white bearing cup must be re-used. To avoid damaging it, **push, DO NOT TAP**, on it in the next step.

24. On the passenger side of the shifter assembly, push the white bearing cup inward with a flat screwdriver, drift, or pin punch. This will release the tension on the top and bottom flats of the cup, allowing the cup to release the pivot pin's ball tip.

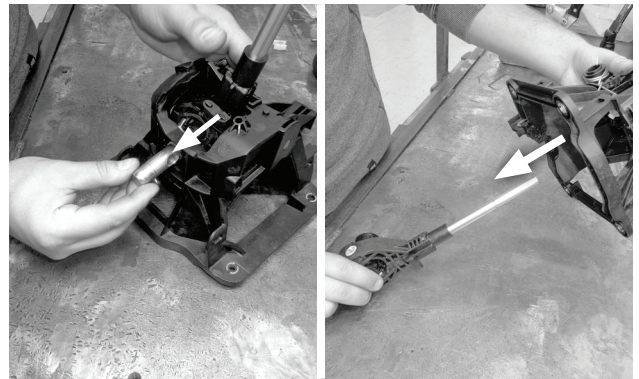

27. Push the short (longitudinal) pivot pin out of the shifter assembly, then remove the shift lever from the shifter housing.

INSTALL THE B&M PRECISION SPORTSHIFTER

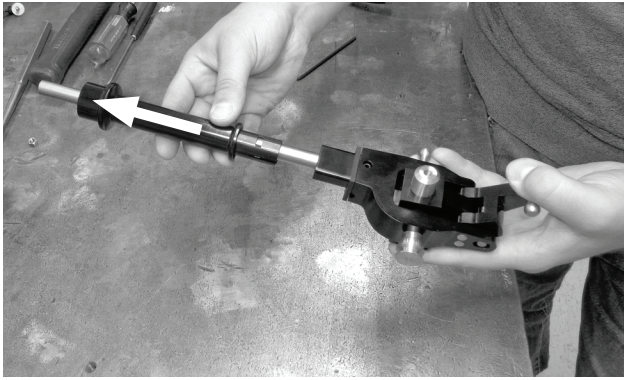

28. Remove the lockout collar from the B&M shift lever.

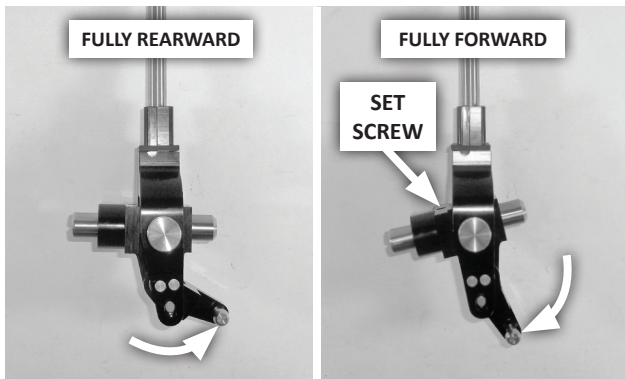

29. At the bottom of the B&M shift lever, note that the gimbal extension has three detents. Push the extension fully forward to provide best access to the set screw in the next step.

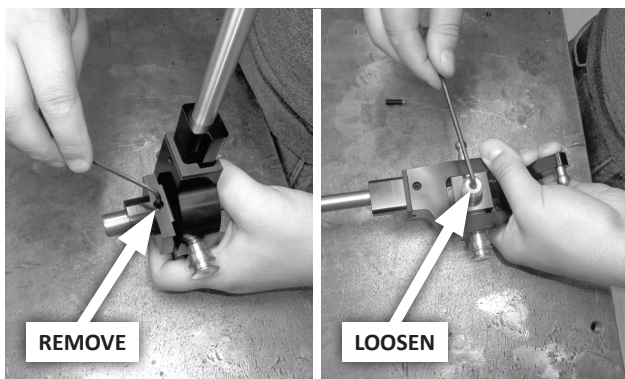

30. Remove the short pivot pin's set screw. Then, at the rear end of the short pivot pin, loosen the long pivot pin's set screw (3-4 turns).

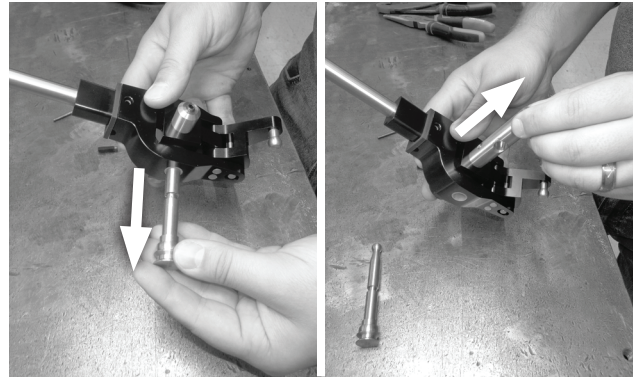

CAUTION: To avoid losing spring-loaded internal parts, do not move the gimbal extension after removing the 2 pivot pins.

31. Remove the long pivot pin, then remove the short pivot pin.

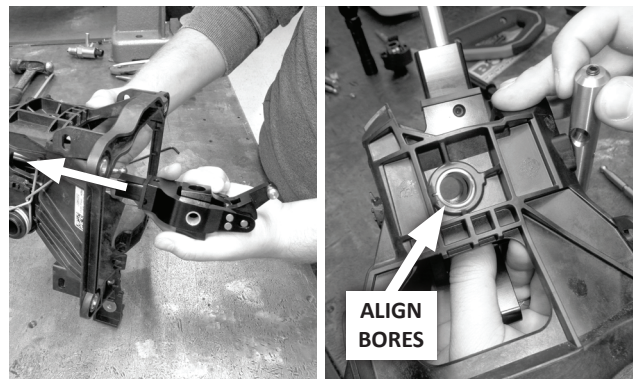

32. Insert the B&M shift lever in the shifter housing, and align the lever and housing's short pivot pin bores.

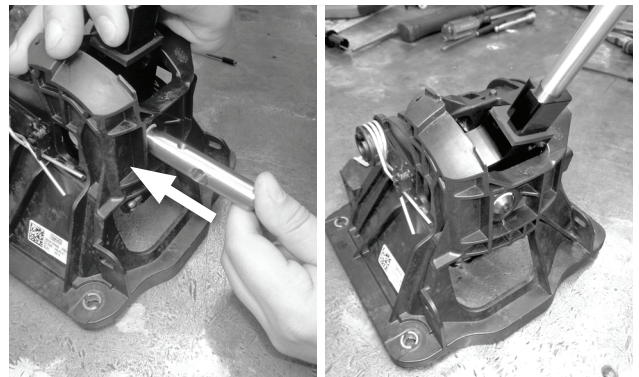

33. Insert the short pivot pin through the aligned bores, slotted end forward, set screw to the rear.

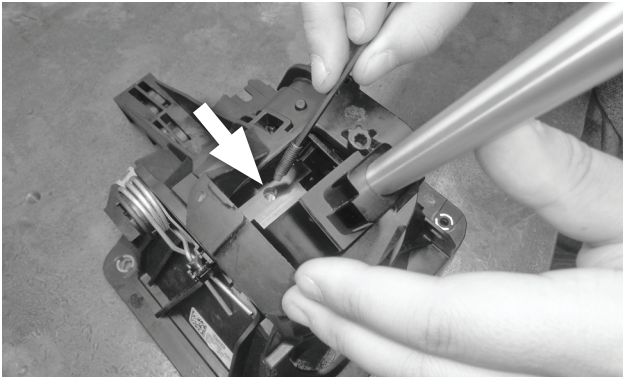

34. Align the threaded set screw hole in the pivot pin with the bore in the gimbal housing, then install and tighten the set screw.

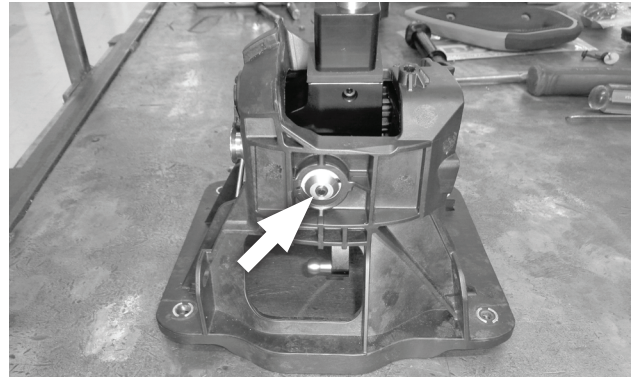

37. In the end of the short pivot pin, tighten the set screw that secures the long pivot pin.

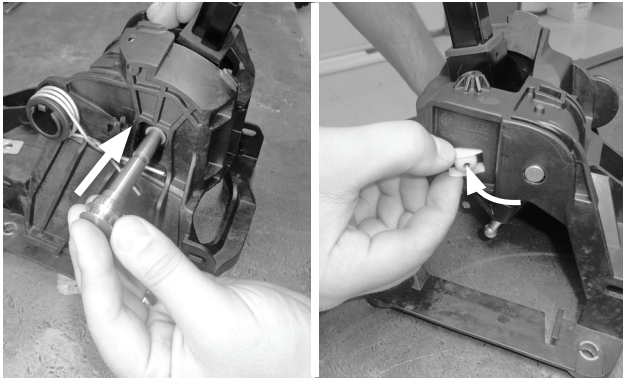

35. Insert the long pivot pin through the housing and shift lever. Then insert the bearing cup in the opposite side of the housing.

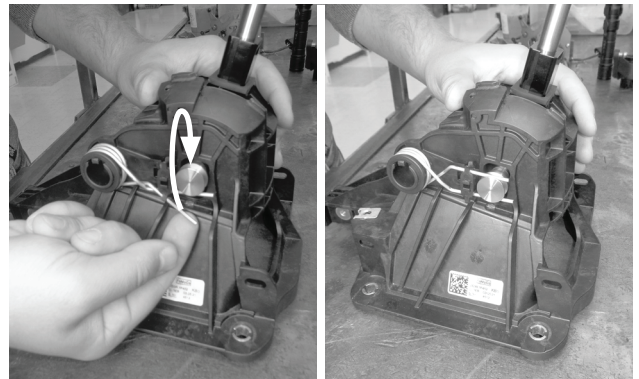

38. Lift the leg of the centering spring up and lay it in the groove in the head of the long pivot pin.

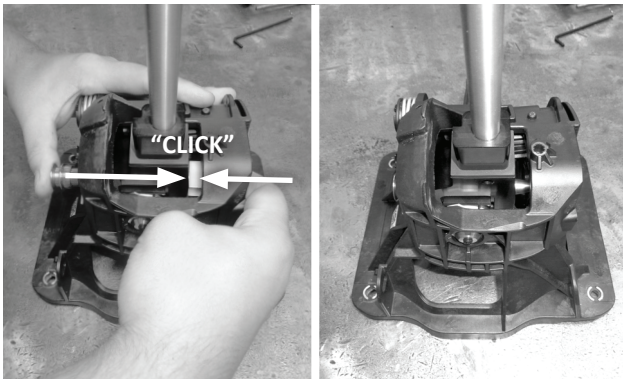

36. Push the pivot pin and the bearing cup toward each other until they snap together.

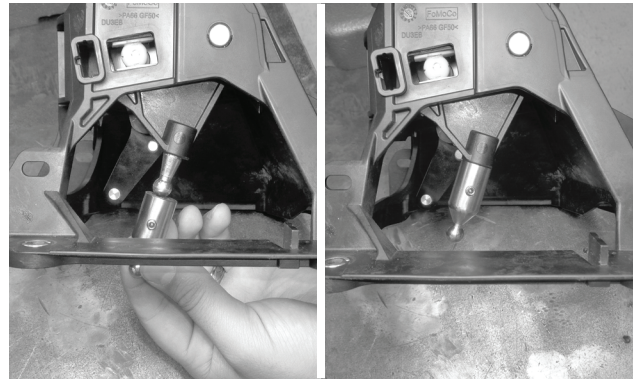

39. Install the ball tip extension on the stock ball tip, and tighten the set screw.

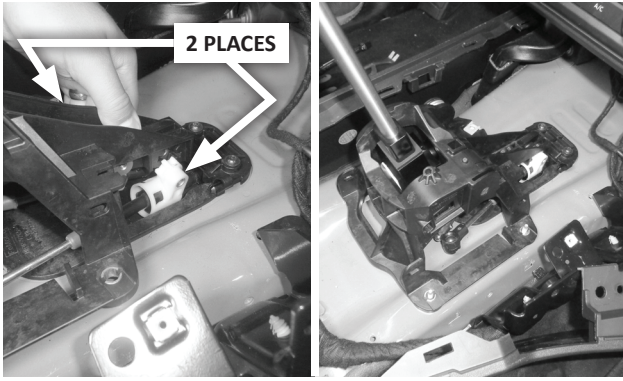

40. Move the shifter assembly into place in the vehicle. First, push the 2 white cable bushings into their cutouts at the front of the shifter housing. Then place the shifter on its mount studs.

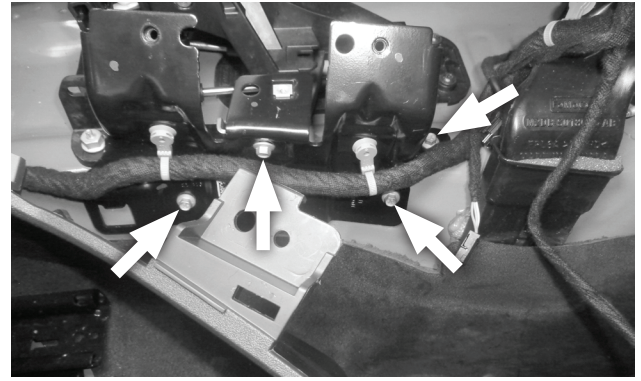

43. Reinstall the passenger side bracket (4 screws).

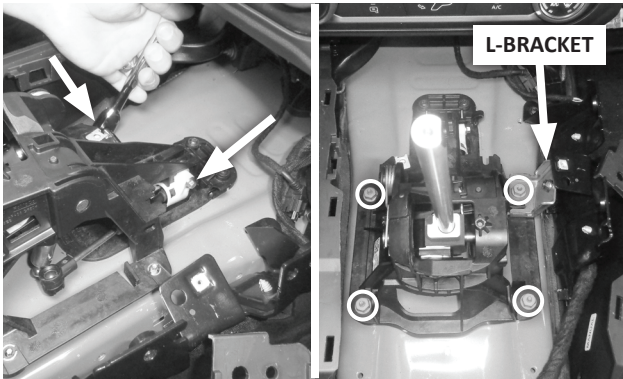

41. Secure the cable bushings to the shifter housing (2 screws). Return the L-bracket to the front passenger side mount stud, then install the 4 shifter mount nuts.

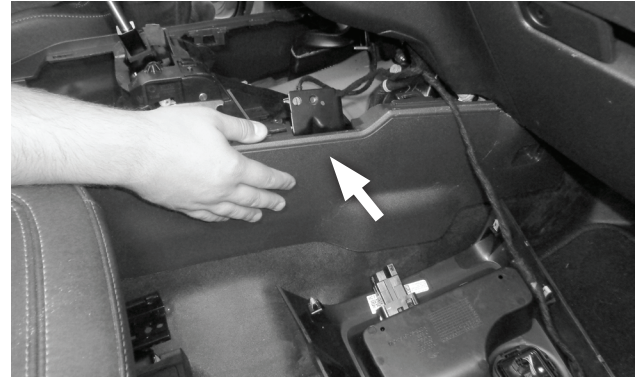

44. Move the passenger side console cover back into position.

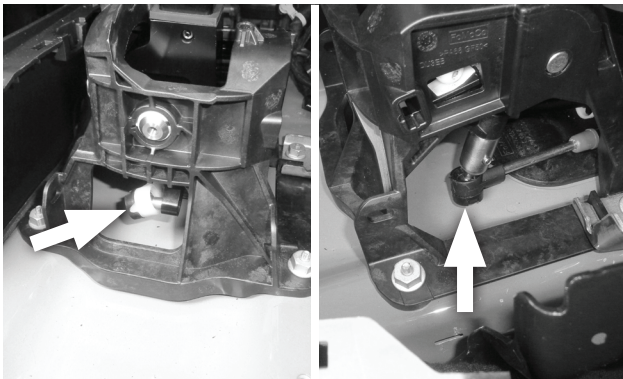

42. Push each cable end on to its respective shift lever ball tip.



45. At the front of the side console cover, reinstall the screw and trim cover. At the rear of the cover, reinstall the plastic push pin.

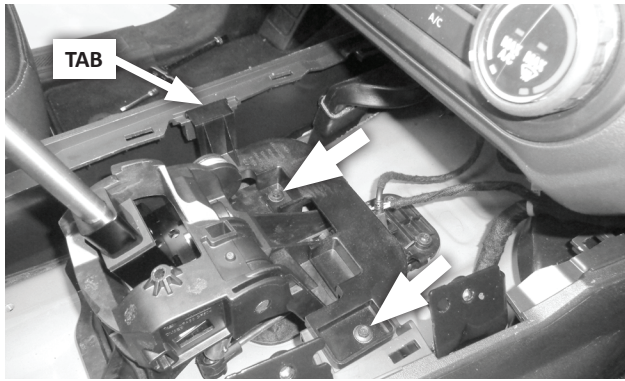

46. Insert the tab on the center bracket in the slot in the driver side console cover. Then fasten the bracket to the shifter housing and passenger side cover (2 screws).

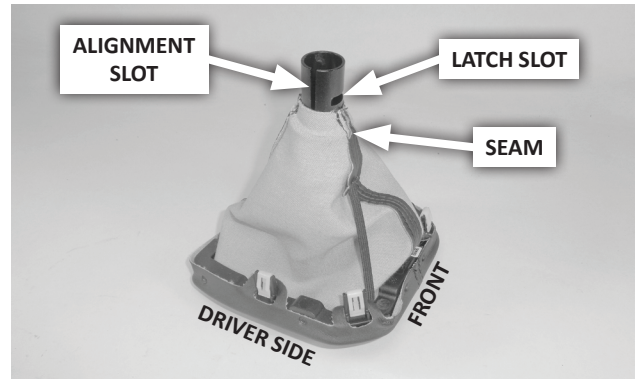

49. Insert the B&M lockout collar in the boot, orienting the collar so that the 2 latch slots align with the 2 boot seams, and the alignment slot faces the driver side of the boot.

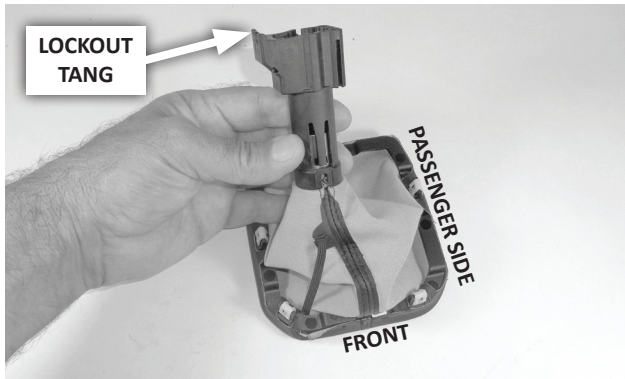

47. Turn the boot assembly inside out. Note that the tang on the lockout sleeve points toward the driver side.

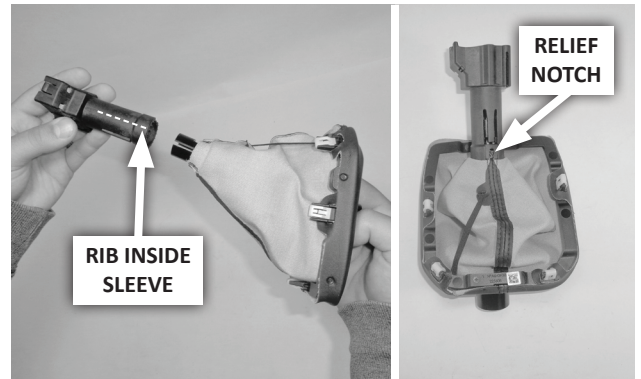

50. While maintaining the collar's orientation in the boot, push the lockout sleeve onto the lockout collar. The rib inside the lockout sleeve will slide into the alignment slot. Push the sleeve onto the collar until the latches click into their slots. Once assembled, verify that the 2 boot seams are aligned with the 2 relief notches on the lockout sleeve.

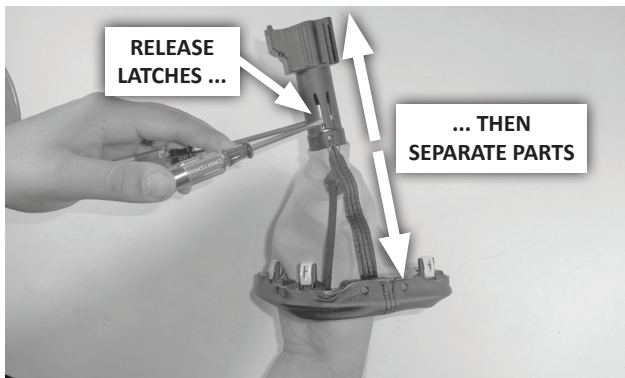

48. Use 2 small flat-tipped screwdrivers to release both latches on the lockout sleeve at the same time. Then disassemble the lockout sleeve, boot, and lockout collar.



51. Install the boot assembly over the shift lever, orienting the lockout tang toward the driver side.



52. Install the lockout spring and bushing in the lockout collar.

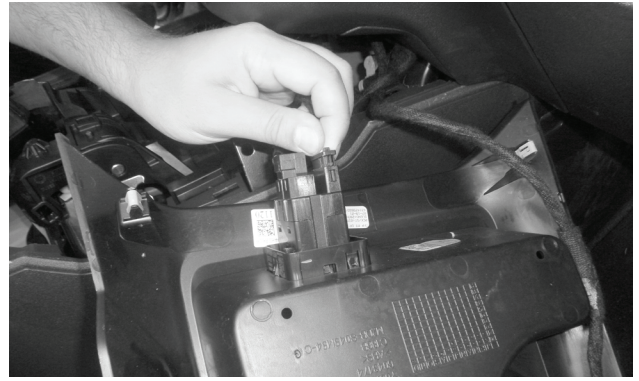

55. Reconnect the 2 electrical plugs to the USB sockets.



NOTE: The top of the B&M shift lever is identical to the stock lever, allowing the use of either the B&M or the stock shift knob.

53. Place the shift knob on the lever, ensure that it's properly aligned to the machined flat, and fasten it with the stock screw.



56. Carefully move the console panel into place above the center console. Feed the boot frame up through the panel opening.



54. Snap the cap onto the shift knob.



57. Snap the boot frame back into place in the console panel.

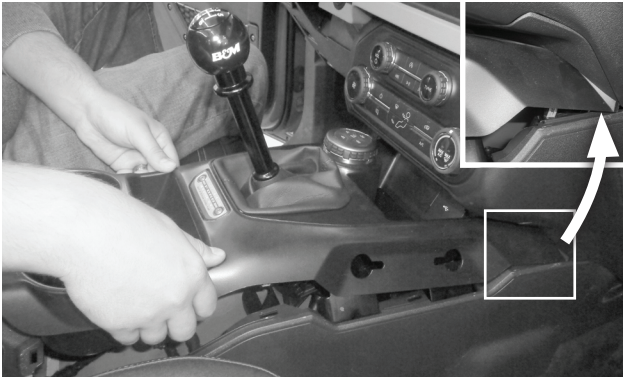

58. Snap the console panel fully back into place on the center console. Note that the front of lip of the panel fits behind (under) the lower edge of the dash.

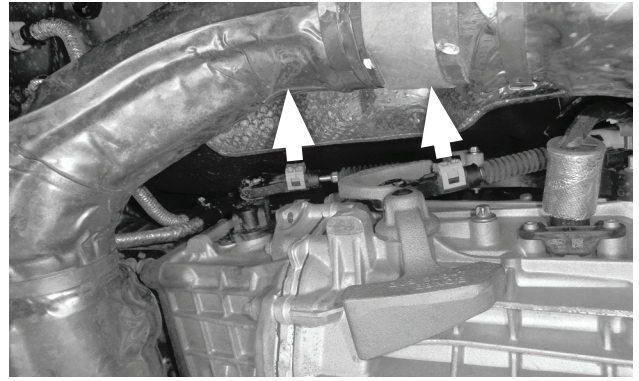

61. Under the vehicle, on the passenger side of the transmission, locate the ends of the 2 shift cables. Release each cable's adjustment clip by pulling it out / away from the cable housing.



59. Reinstall the passenger grab handle (2 screws).



62. Inside the vehicle, verify that the shifter is still in Neutral.

ADJUST THE SHIFT CABLES



60. Move the shifter to Neutral (center of the pattern, between 3rd and 4th).

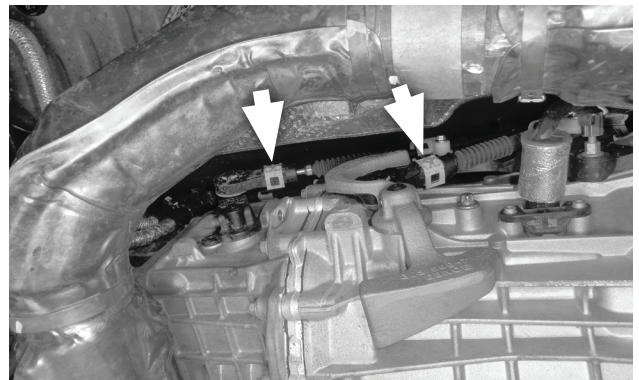

63. Under the vehicle, lock each adjusting cable by pushing it back in against the cable.

Congratulations, your B&M Precision Sportshifter is now installed and ready to enjoy!

KEEP THESE INSTRUCTIONS FOR FUTURE REFERENCE

B&M Performance maintains a highly-trained technical service department to answer your technical questions, provide additional product information and offer various recommendations.

B&M TECHNICAL SUPPORT: (866) 464-6553